



**Product:** [RSRK 30-6049](#)

7/8" Power Double-Ended Cordset: Male straight to Female straight, 3-pin(2+PE), yellow body, 600V(UL Referenced), 9 A; PVC yellow cable, 1.00 mm<sup>2</sup>

**Product Description**

7/8" Power Double-Ended Cordset: Male straight to Female straight, 3-pin(2+PE), yellow body, 600V(UL Referenced), 9 A; PVC yellow cable, 1.00 mm<sup>2</sup>

**Technical Drawing**

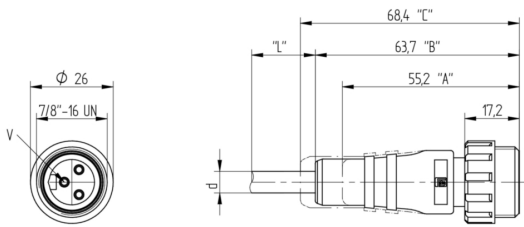

	"A"	"B"	"C"
d	≤ Ø 5	Ø 5 < d ≤ Ø 10,5	> Ø 7,5... < Ø 14

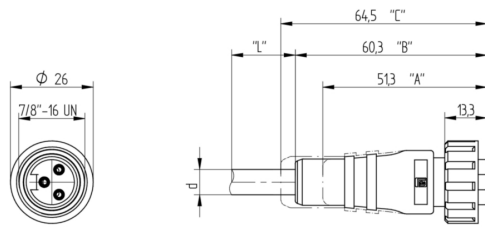

	"A"	"B"	"C"
d	≤ Ø 5	Ø 5 < d ≤ Ø 10,5	> Ø 7,5... < Ø 14

**Male**

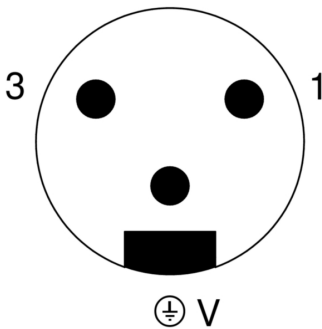

**Female**

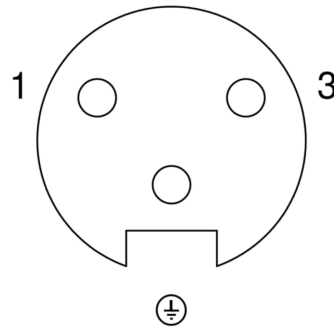

**Technical Specifications**

Face View Side 1

Pin 1	Pin 2	Pin 3
green	black	white

Face View Side 2

Pin 1	Pin 2	Pin 3
green	black	white

## Product Description

Product Family:	Power Connector
Brand:	Lumberg Automation
Connector Type:	Cordset, double ended
Shielding Type:	Unshielded
Voltage Rating:	600 V AC/DC
Operating Voltage:	300 V DC/AC
Current Rating:	9 A

## Technical Data Side 1

Side 1 Product Sub Family:	7/8" Circular Connectors
Side 1 Type of Contact/Gender:	male
Connector Design:	7/8"   Male   3 Pole   0°
Attachment Type:	Coupling nut
Number of Pins:	3
Side 1 Contact Resistance:	≤ 10 mOhm
Insulation Resistance:	> 10 <sup>9</sup> Ohm
Ambient Temperature (Operation)*:	-40 °C to +90 °C
Contact Base Material:	CuZn
Side 1 Contact Plating:	Ag/Au
Contact Bearer Material:	TPU
Contact Bearer Color:	orange
Molded Body Material:	TPU
Molded Body Color:	Yellow
Attachment Material:	PA, black
Note:	Do not connect / disconnect under load.

## Cable Data

Cable Number:	6049
Conductor Size:	1 mm <sup>2</sup>
Number of Wires:	3
Cycles (Bending):	≥ 5 million cycles (1m Travel Distance, 20cycles/min, 1.5m/s)
Conductor Material:	Cu
Cable Jacket Material:	PVC
Cable Jacket Color:	Yellow
Cable Diameter D:	ø 6.40 mm
Wire Insulation Material:	PE
Insulated Wire Diameter:	ø 2.15 mm
Ambient Temperature (Fixed Installation):	- 40 °C to +80 °
UL Cable Type:	AWM: 22438
Flammability Class (Cable Jacket):	FT2, IEC 60332-1-2

## Technical Data Side 2

Side 2 Product Sub Family:	7/8" Circular Connectors
Side 2 Type of Contact/Gender:	female
Connector Design, Side 2:	7/8"   Female   3 Pole   0°
Attachment Type, Side 2:	Coupling Nut
Number of Pins, Side 2:	3
Contact Resistance, Side 2:	≤ 10 mOhm
Insulation Resistance, Side 2:	> 10 <sup>9</sup> Ohm
Ambient Temperature (Operation), Side 2*:	-40 °C to +90 °C
Contact Base Material, Side 2:	CuZn
Contact Plating, Side 2:	Ag/Au
Contact Bearer Material, Side 2:	TPU
Contact Bearer Color, Side 2:	orange
Molded Body Material, Side 2:	TPU

Molded Body Color, Side 2:	Yellow
Attachment Material, Side 2:	PA, black
Note, Side 2:	Do not connect / disconnect under load.

## Safety & Environmental Compliance

RoHS Compliant:	yes
-----------------	-----

## Notes

Note Derating:	* Notice derating
----------------	-------------------

## Variants

Item #	Item Description	Cable Length
960491101	RSRK 30-6049/1 M	1.0 m
960491102	RSRK 30-6049/2 M	2.0 m
960491105	RSRK 30-6049/5 M	5 m
9604911010	RSRK 30-6049/10 M	10 m

© 2026 Belden, Inc

All Rights Reserved.

Although Belden makes every reasonable effort to ensure their accuracy at the time of this publication, information and specifications described here in are subject to error or omission and to change without notice, and the listing of such information and specifications does not ensure product availability.

Belden provides the information and specifications herein on an "ASIS" basis, with no representations or warranties, whether express, statutory or implied. In no event will Belden be liable for any damages (including consequential, indirect, incidental, special, punitive, or exemplary damages) whatsoever, even if Belden has been advised of the possibility of such damages, whether in an action under contract, negligence or any other theory, arising out of or in connection with the use, or inability to use, the information or specifications described herein.

All sales of Belden products are subject to Belden's standard terms and conditions of sale.

Belden believes this product to be in compliance with all applicable environmental programs as listed in the data sheet. The information provided is correct to the best of Belden's knowledge, information and belief at the date of its publication. This information is designed only as a general guide for the safe handling, storage, and any other operation of the product itself or the one that it becomes a part of. The Product Disclosure is not to be considered a warranty or quality specification. Regulatory information is for guidance purposes only. Product users are responsible for determining the applicability of legislation and regulations based on their individual usage of the product.