



**Product:** [RKHS 8Y-922](#)

Fast Ethernet Cat5e Data Single-Ended Cordset: M12 Hybrid Receptacle, female, straight, 8-pin, Y-coded, shielded, black body, 50 V AC/ DC, 0.5 A; PUR black cable, 8-wires, Data: 4x0.15 mm<sup>2</sup> + Power: 4x0.75 mm<sup>2</sup>

**Product Description**

Fast Ethernet Cat5e Data Single-Ended Cordset: M12 Hybrid Receptacle, female, straight, 8-pin, Y-coded, shielded, black body, 50 V AC/ DC, 0.5 A; PUR black cable, 8-wires, Data: 4x0.15 mm<sup>2</sup> + Power: 4x0.75 mm<sup>2</sup>

**Technical Drawing**

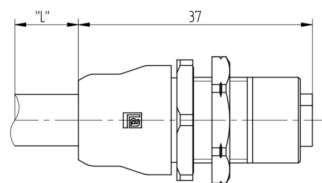
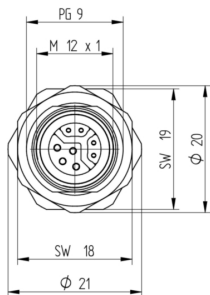

**Female**

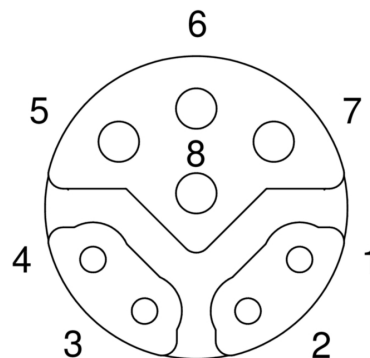

**Technical Specifications**

**Face View**

Pin 1	Pin 2	Pin 3	Pin 4	Pin 5	Pin 6	Pin 7	Pin 8
white-orange	orange	white-green	green	blue	white	brown	black

**Technical Data**

Product Family:	Data Connectors
Product Sub Family:	M12 Hybrid Receptacle
Brand:	Lumberg Automation
Connector Type:	Cordset, single ended
Type of Contact / Gender:	Female
Connector Design:	Straight
Number of Pins:	8
Coding:	Y
Shielding:	Shielded
Attachment Type:	Coupling Nut
Rated Voltage:	50 V
Rated Voltage (UL):	50 V AC/DC
Rated Impulse Voltage:	0.8 kV
Operating Voltage:	50 V AC/ DC
Rated Current*:	Power: 6 A; Data: 0.5 A
Rated Current (UL)*:	Power: 6 A; Data: 0.5 A

Data Transmission:	Fast Ethernet Cat5e
Data Transmission Rate:	100 Mbit/s
Contact Resistance:	≤ 10 mOhm
Insulation Resistance:	> 10 <sup>9</sup> Ohm
Mating Cycles:	≤ 100
Ambient Temperature (Operation)*:	- 40 °C - + 90 °C
Operating Temperature (UL):	max. + 80 °C
Protection Degree / IP Rating**:	IP65, IP67, IP69K
Design Standard:	IEC 61076-2-113
Pollution Degree:	3 acc. to DIN EN 60664-1 (VDE 0110-1)
Overvoltage Category:	III acc. to DIN EN 60664-1 (VDE 0110-1)

## Materials

Contact Base Material:	CuZn
Contact Plating:	Cu/Au
Contact Bearer Material:	PBT-GF
Contact Bearer Color:	Black
Flammability Class (Contact Bearer):	Data: UL 94 V-2 + Power: UL 94 V-0
Molded Body Material:	TPU
Molded Body Color:	Black
Flammability Class (Molded Body):	UL 94 HB
Housing Material:	CuZn, Nickel-plated
Attachment Material:	CuZn
Attachment Plating:	Nickel-plated
Shielding Material:	Housing: CuZn, tin-plated, Sleeve: GD-Zn, nickel-plated

## Cable Data

Cable Number:	922
Conductor Size:	Data: 4x0.15 mm <sup>2</sup> + Power: 4x0.75 mm <sup>2</sup>
Number of Wires:	8
Minimal Bending Radius (Fixed Inst):	> 6 x D
Minimal Bending Radius (Flexible Inst):	> 10 x D
Cycles (Bending):	> 1-2 M
Conductor material:	Cu
Cable Jacket Material:	PUR
Cable Jacket Color:	black matt similarly RAL 9005
Cable Diameter D:	ø 8.00 ± 0.3 mm
Wire Insulation Material:	PP
Insulated Wire Diameter:	Data: ø 1.15 ± 0.03 mm + Power: ø 1.70 ± 0.05 mm
Overall Shield (Cable):	Cu-ETP1 tinned
Element Shield:	Shielding Foil
Ambient Temperature (Fixed Installation):	- 40 °C - + 90 °C (UL: + 80 °C)
Ambient Temperature (Flex Installation):	- 30 °C - + 70 °C
UL Cable Type:	AWM: 20233
Cable Characteristics:	Exclusion of dangerous materials; Exclusion of PVC and Silicone
Core Colors:	Data: green, orange, white-green, white-orange + Power: brown, black, white, blue

## Approvals

UL-File:	E315587
UL:	UL 2238; cULus

## Safety & Environmental Compliance

RoHS Compliant:	yes
-----------------	-----

## Resistances

Halogenfree:	EN 50267-2-1, IEC 60754-1 max. 0.5% HCl
Oil Resistance:	IEC 60811-2-1, ASTM 1 standard oil requirement

## Notes

Note Derating:	Notice derating
Protection Degree / IP Rating Note:	** only if mounted and locked in combination with Hirschmann / Lumberg Automation connector.
Note:	Do not connect or disconnect under load.

## Variants

Item #	Item Description	Cable Length
20974	RKHS 8Y-922/1 M	1 m
934926001	RKHS 8Y-922/2 M	2 m
934926002	RKHS 8Y-922/5 M	5 m
934926003	RKHS 8Y-922/10 M	10 m
934926004	RKHS 8Y-922/15 M	15 m
934926005	RKHS 8Y-922/20 M	20 m
934926006	RKHS 8Y-922/25 M	25 m

© 2024 Belden, Inc

All Rights Reserved.

Although Belden makes every reasonable effort to ensure their accuracy at the time of this publication, information and specifications described here in are subject to error or omission and to change without notice, and the listing of such information and specifications does not ensure product availability.

Belden provides the information and specifications herein on an "ASIS" basis, with no representations or warranties, whether express, statutory or implied. In no event will Belden be liable for any damages (including consequential, indirect, incidental, special, punitive, or exemplary damages) whatsoever, even if Belden has been advised of the possibility of such damages, whether in an action under contract, negligence or any other theory, arising out of or in connection with the use, or inability to use, the information or specifications described herein.

All sales of Belden products are subject to Belden's standard terms and conditions of sale.

Belden believes this product to be in compliance with all applicable environmental programs as listed in the data sheet. The information provided is correct to the best of Belden's knowledge, information and belief at the date of its publication. This information is designed only as a general guide for the safe handling, storage, and any other operation of the product itself or the one that it becomes a part of. The Product Disclosure is not to be considered a warranty or quality specification. Regulatory information is for guidance purposes only. Product users are responsible for determining the applicability of legislation and regulations based on their individual usage of the product.