

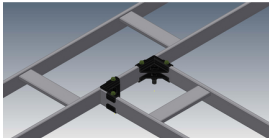

Product: [Junction Splice Kit](#)



Junction-Splice Kit - UL Classified

Product Description

Junction-Splice Kit - UL Classified

Technical Specifications

Application

Product Overview:	Used to create a 90° junction splice with all types of 1.5" x .375" cable runway. Features Belden patent pending quick bonding system.
Benefits:	Used to create a 90° junction splice with all types of 1.5" x .375" cable runway., Features Belden patent pending quick bonding system.
Features:	Belden patent pending quick bonding system
Environmental Space:	Indoor

Environmental and Overall Characteristics

Finish:	Black Zinc & Powdercoat Finish
Material:	Steel
Color:	Black
Weight:	1.0 lb

Related Part Numbers

Part Number:	BLJSU302-15B
Included Parts:	Kit consists of: (4) corner clamp plates, (2) 3/8"-16 x 1.25" trimmed head bolts, (4) 10-32 x 1/2" grounding screw, (2) 3/8"-16 hex nuts, (2) 3/8" split lock washers.
Packaging:	Individually Boxed

Variants

Part #	Description	Color	Included Parts	Shipping Weight
BLJSU302-15B	Junction-Splice Kit - UL Classified	Black	Kit consists of: (4) corner clamp plates, (2) 3/8"-16 x 1.25" trimmed head bolts, (4) 10-32 x 1/2" grounding screw, (2) 3/8"-16 hex nuts, (2) 3/8" split lock washers.	1.0 lb
Update and Revision:		Revision Number: 0.98 Revision Date: 11-09-2022		

© 2025 Belden, Inc

All Rights Reserved.

Although Belden makes every reasonable effort to ensure their accuracy at the time of this publication, information and specifications described here in are subject to error or omission and to change without notice, and the listing of such information and specifications does not ensure product availability.

Belden provides the information and specifications herein on an "ASIS" basis, with no representations or warranties, whether express, statutory or implied. In no event will Belden be liable for any damages (including consequential, indirect, incidental, special, punitive, or exemplary damages) whatsoever, even if Belden has been advised of the possibility of such damages, whether in an action under contract, negligence or any other theory, arising out of or in connection with the use, or inability to use, the information or specifications described herein.

All sales of Belden products are subject to Belden's standard terms and conditions of sale.

Belden believes this product to be in compliance with all applicable environmental programs as listed in the data sheet. The information provided is correct to the best of Belden's knowledge, information and belief at the date of its publication. This information is designed only as a general guide for the safe handling, storage, and any other operation of the product itself or the one that it becomes a part of. The Product Disclosure is not to be considered a warranty or quality specification. Regulatory information is for guidance purposes only. Product users are responsible for determining the applicability of legislation and regulations based on their individual usage of the product.