

**Product:** [ELST 4012 PG9](#) 



M12 Field Attachable Connector: male, straight, 4-pin, A-coded, unshielded, black housing, screw type, 230 V AC/DC

**Product Description**

M12 Field Attachable Connector: male, straight, 4-pin, A-coded, unshielded, black housing, screw type, 230 V AC/DC

**Technical Drawing**

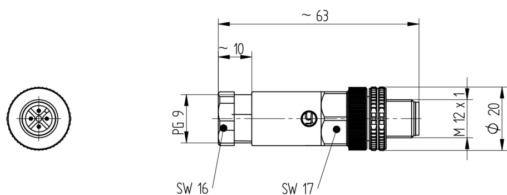

**Technical Specifications**

**Technical Data**

Product Family:	Sensor / Actuator Connectors
Side 1 Product Sub Family:	M12 Standard
Brand:	Belden
Connector Type:	Field attachable
Side 1 Type of Contact/Gender:	male
Connector Design:	straight
Number of Pins:	4
Coding, Side 1:	A
Attachment Type:	Coupling Screw
Voltage Rating:	250 V
Rated Voltage (CSA):	250 V AC/DC
Rated Impulse Voltage:	2.5 kV
Operating Voltage:	230 V AC/DC
Current Rating:	4 A
Rated Current (CSA)*:	4 A
Side 1 Contact Resistance:	≤ 10 mOhm
Insulation Resistance:	> 10 <sup>9</sup> Ohm
Mating Cycles:	≤ 20
Type of Connection:	screw terminal
Maximum Wire Cross Section:	max. 0,75 mm <sup>2</sup>

Cable Gland:	PG9
Strain-Relief:	clamping cage
Suitable Cables:	Ø6 - Ø8 mm
Ambient Temperature (Operation)*:	-25°C to +90°C
Protection Degree / IP Rating**:	IP65, IP67
Side 1 Design Standard:	IEC 61076-2-101
Side 1 Pollution Degree:	3 acc. to DIN EN 60664-1 (VDE 0110-1)
Clearance / Creepage Distance:	DIN EN 60664-1 (2008/01); VDE 0110-1
Overvoltage Category:	II acc. to DIN EN 60664-1 (VDE 0110-1)

## Materials

Contact Base Material:	CuZn
Side 1 Contact Plating:	Cu/Sn
Contact Bearer Material:	PA
Contact Bearer Color:	black
Flammability Class (Contact Bearer):	UL 94 V-2
Housing Material:	PA-GF
Housing Color:	black
Flammability Class (Housing):	UL 94 V-0
Cable Gland Material:	PA-GF
Cable Gland Gasket:	CR, black
Attachment Material:	GD-Zn
Attachment Plating:	nickel-plated
O-Ring Material:	NBR

## Additional Technical Data

Fastening Torque (Attachment):	M 12x1: (50-60) Ncm, hand-tight
--------------------------------	---------------------------------

## Safety & Environmental Compliance

RoHS Compliant:	yes
-----------------	-----

## Notes

Note Derating:	* Notice derating
Protection Degree / IP Rating Note:	** only if mounted and locked in combination with Hirschmann / Lumberg Automation connector.

## Variants

Item #	Item Description
933162100	ELST 4012 PG9

© 2026 Belden, Inc

All Rights Reserved.

Although Belden makes every reasonable effort to ensure their accuracy at the time of this publication, information and specifications described here in are subject to error or omission and to change without notice, and the listing of such information and specifications does not ensure product availability.

Belden provides the information and specifications herein on an "ASIS" basis, with no representations or warranties, whether express, statutory or implied. In no event will Belden be liable for any damages (including consequential, indirect, incidental, special, punitive, or exemplary damages) whatsoever, even if Belden has been advised of the possibility of such damages, whether in an action under contract, negligence or any other theory, arising out of or in connection with the use, or inability to use, the information or specifications described herein.

All sales of Belden products are subject to Belden's standard terms and conditions of sale.

Belden believes this product to be in compliance with all applicable environmental programs as listed in the data sheet. The information provided is correct to the best of Belden's knowledge, information and belief at the date of its publication. This information is designed only as a general guide for the safe handling, storage, and any other operation of the product itself or the one that it becomes a part of. The Product Disclosure is not to be considered a warranty or quality specification. Regulatory information is for guidance purposes only. Product users are responsible for determining the applicability of legislation and regulations based on their individual usage of the product.