

Product: [0911 ANC 408](#) 

Asi line connectors



Product Description

Asi line connectors

Technical Drawing

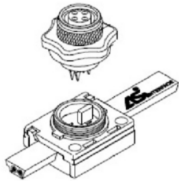
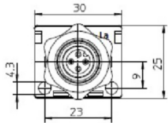
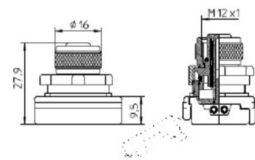

Technical Specifications

Product Description

Brand:	Belden
Product Family:	ASi
Product Sub Family:	ASi
Item Description:	0911 ANC 408
I/O Connection:	M12, 4/2-poles, A-coded
Number of ports:	1

General Data

Housing Material:	Plastic, PA
Housing Color:	Orange
Protection Degree / IP Rating**:	IP67
Potted:	No
Dimensions (W x H x D):	30 mm x 28 mm x 25 mm
Ambient Temperature (Operation)*:	-25 °C to 80 °C
Contact Bearer Material:	PA
O-Ring Material:	FKM
Fastening Torque (I/O Connection):	M12: 0,5 Nm

Power Supply

Actuator Supply Voltage (Nominal):	24 V DC (SELV/PELV)
Actuator Supply Voltage (Range):	10 V DC to 30 V DC

Digital Input Channels

Input Wiring:	2-, 3-, 4-wire
---------------	----------------

Digital Output Channels

Galvanically Isolated:	No
------------------------	----

Safety & Environmental Compliance

CE:	Yes
RoHS Compliant:	Yes

Notes

Protection Degree / IP Rating Note:	** only if mounted and locked in combination with Hirschmann / Lumberg Automation connector.
System Power Supply Connection Note:	*do not connect / disconnect under voltage!

Variants

Item #	Item Description
10933	0911 ANC 408

Update and Revision:	Revision Number: 0.38 Revision Date: 04-08-2022
----------------------	---

© 2022 Belden, Inc

All Rights Reserved.

Although Belden makes every reasonable effort to ensure their accuracy at the time of this publication, information and specifications described here in are subject to error or omission and to change without notice, and the listing of such information and specifications does not ensure product availability.

Belden provides the information and specifications herein on an "ASIS" basis, with no representations or warranties, whether express, statutory or implied. In no event will Belden be liable for any damages (including consequential, indirect, incidental, special, punitive, or exemplary damages) whatsoever, even if Belden has been advised of the possibility of such damages, whether in an action under contract, negligence or any other theory, arising out of or in connection with the use, or inability to use, the information or specifications described herein.

All sales of Belden products are subject to Belden's standard terms and conditions of sale.

Belden believes this product to be in compliance with all applicable environmental programs as listed in the data sheet. The information provided is correct to the best of Belden's knowledge, information and belief at the date of its publication. This information is designed only as a general guide for the safe handling, storage, and any other operation of the product itself or the one that it becomes a part of. The Product Disclosure is not to be considered a warranty or quality specification. Regulatory information is for guidance purposes only. Product users are responsible for determining the applicability of legislation and regulations based on their individual usage of the product.