

NOTES:

1. ALL THREADED HARDWARE TO BE MASKED SO AS TO BE FREE FROM POWDER COAT THIS INCLUDES ALL PEM NUTS, ALL CD STUDS, AND ALL PEM STUDS IN THE RACKS.

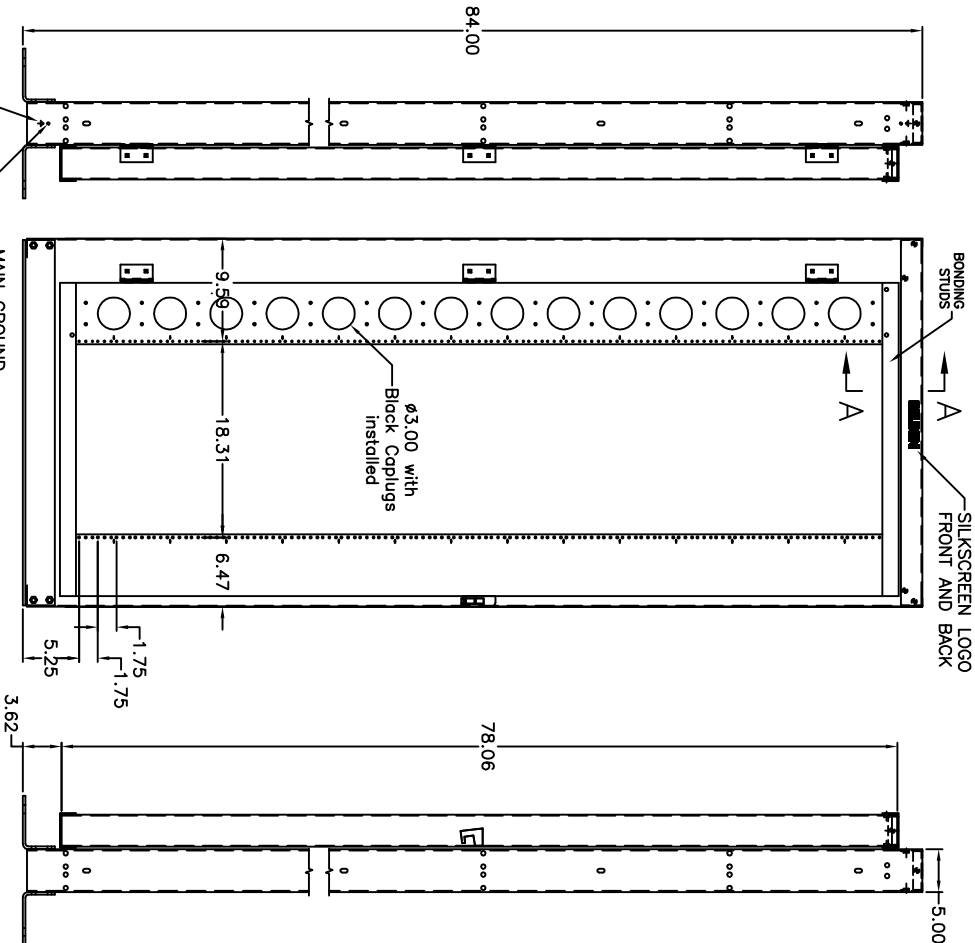
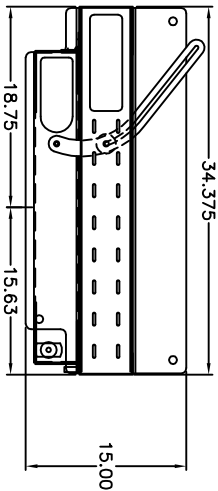
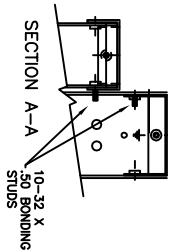

GROUND SYMBOL MARKED INSIDE CHANNEL NEAR EACH STUD

MAIN GROUND 1/4-20 X 3/4 PEM STUD INSIDE OF CHANNEL TOP AND BOTTOM

DO NOT SCALE THIS DRAWING

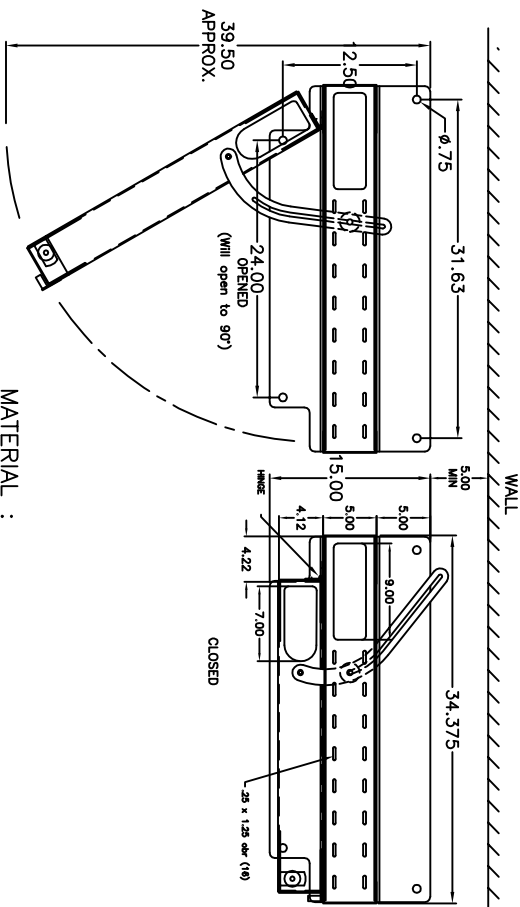

MATERIAL :

HINGES 14 GA (.075) STEEL

BOTTOM ANGLES 1/4" STEEL

ALL FRAME PARTS ARE 12 GA (.105) STEEL EXCEPT TOP & BOTTOM REAR CHANNEL AND STOP CHANNEL ARE 14 GA (.075) STEEL.

CONSTRUCTION:

BOLTED CONSTRUCTION

FINISH:

POWDER COATED BLACK

THIS DRAWING AND ALL INFORMATION CONTAINED HEREIN IS THE PROPERTY OF BELDEN. ANY USE, COPY OR REPRODUCTION OF THIS MATERIAL WITHOUT WRITTEN PERMISSION OF BELDEN IS PROHIBITED.

BELDEN

REMOVED NOTE 2 JWP 9/5/2014
SHOW SECTION A-A, BONDING STUDS AGJ 3/16/09

TECHNICAL

SWING OUT DISTRIBUTION RACK
SERIES MASTER

XSW-SERIES MASTER